

**DIMENSIONS (mm) :**

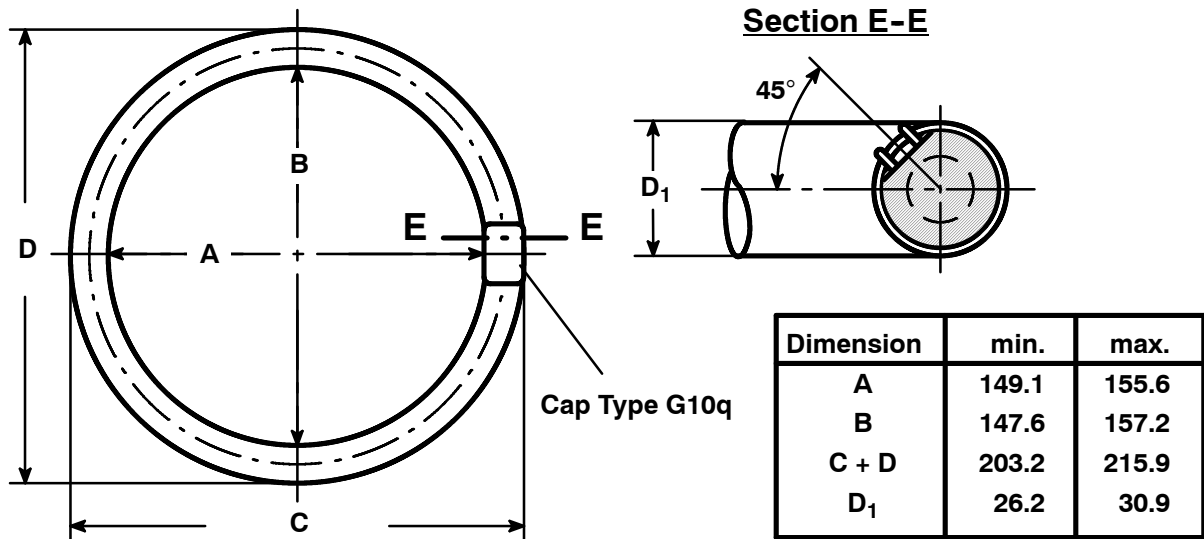

Cap: G13 ( IEC61-1 sheet 7004-51-7 )

**ELECTRICAL DATA**

		<u>NOMINAL VALUE</u>	<u>MIN.</u>	<u>MAX.</u>
Frequency	(Hz) :	50		
Lamp nominal wattage	(W) :	22		
Lamp rated wattage	single operation (W) :	22.0	20.4	23.6
	series operation (W) :	46.0		
Lamp operating voltage	(r.m.s.) (V) :	62.0	55.0	69.0
Lamp current	single operation (mA) :	400		
	series operation (mA) :			430
Preheat current	single operation (mA) :	600	360	840
	series operation (mA) :			840

**OPERATING CONDITIONS**

		<u>NOMINAL VALUE</u>	<u>MIN.</u>	<u>MAX.</u>
Lamp ambient temperature	(°C) :		-20	
Ballast	single operation (Ω/V) :	540/220, 580/230, 610/240		
	series operation (Ω/V) :	390/220, 420/230, 452/240		
Starter	single operation :	FS-11, FS-22, COP-22, COP-11		
	series operation :	FS-22, COP-22		
Burning position	:	any		

**LAMP LIFE \***

Average life (50% failure rate)	(h) :	7500
Individual life	(h) :	3000

**ATTENTION:**

This UV energy source emits UV radiation. Avoid exposure to skin and eyes. Lamps comply with the requirements of EN 60901 and EN 61199, respectively. Starter and ballast must comply with EN 60155 and EN 60921, respectively.  
\* Life test according to EN 60081, Annex C.1.

Issued by : SLI Lichtsysteme  
Date : 14.09.2004  
Revision Date :

### DATA SHEET

Specification No.: 51P-5915  
Supersedes :  
Page 1 of 3

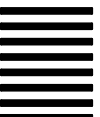

### PHOTOMETRIC DATA:

COLOUR	No.	UV-A irradiance 1m distance bare lamp (315-400nm) ( $\mu\text{W}/\text{cm}^2$ )	UV-B irradiance 1m distance bare lamp (280-315nm) ( $\mu\text{W}/\text{cm}^2$ )	ILCOS-Code
BLACKLIGHT average at 0 h		37,40	0,26	XUV/FC-22-E-G10q-29

### ATTENTION:

This UV energy source emits UV radiation. Avoid exposure to skin and eyes.  
Lamps comply with the requirements of EN 60901 and EN 61199, respectively.  
Starter and ballast must comply with EN 60155 and EN 60921, respectively.  
\* Life test according to EN 60081, Annex C.1.

Issued by : SLI Lichtsysteme  
Date : 14.09.2004  
Revision Date :

## DATA SHEET

Specification No.: 51P-5915  
Supersedes :  
Page 2 of 3

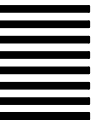

### Evaluation acc. to EN60335-2-59

MW FC22WBL350

0 h

**A) Spectral Irradiance vs. Wavelength**

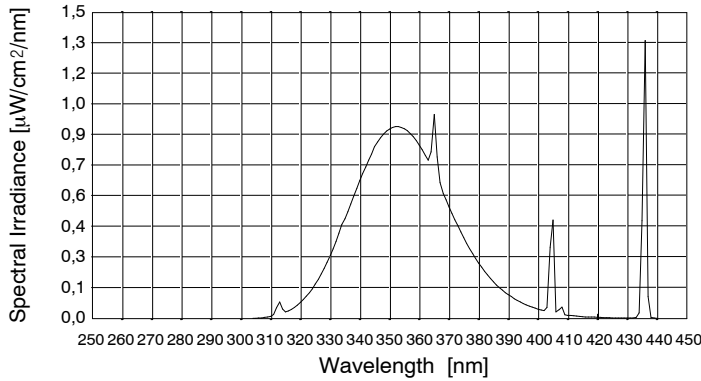

**Spectral Irradiance @ 1m distance**

**UVA = 37,40 μW/cm<sup>2</sup>**  
**UVB = 0,26 μW/cm<sup>2</sup>**  
**UVB/UVA = 0,69%**  
 Wavelength range acc. to CIE  
 UVA : 315 – 400 nm  
 UVB : 280 – 315 nm  
**Lamp parameter:**  
**Voltage: 62V**  
**Current: 0,400A**  
**Power: 22,0W**

**B) UV Action Curve vs. Wavelength**

Proposal of the British Committee to amend EN 60335-2-59 :1997: Insect killers

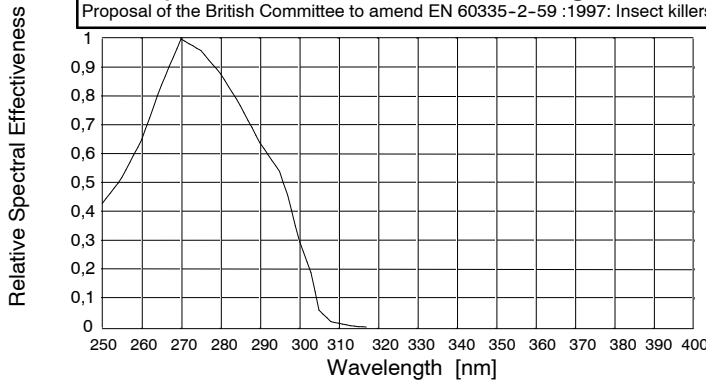

**Acc. to EN 60335-2-59 : 1997**  
**CLC/TC61(GB)579**

**Total Effective Irradiance @ 1m distance**  
**Max. 1 mW/m<sup>2</sup>**

Reason: to ensure that the ICNIRP 8 hour effective radiant exposure limit for the eyes and skin of 30 J/m<sup>2</sup> is not exceeded

**C) Total Effective Irradiance vs. Wavelength = A) x B)**

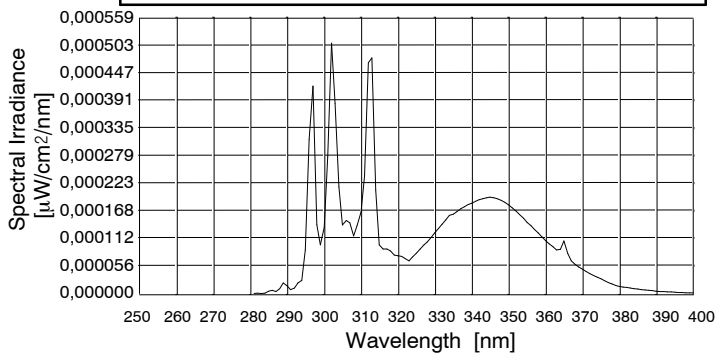

**Total Effective Irradiance @ 1m distance**  
**0,125 mW/m<sup>2</sup>**

Datenfile: MWFC22WBL350.dat

**ATTENTION:**

This UV energy source emits UV radiation. Avoid exposure to skin and eyes.  
 Lamps comply with the requirements of EN 60901 and EN 61199, respectively.  
 Starter and ballast must comply with EN 60155 and EN 60921, respectively.  
 \* Life test according to EN 60081, Annex C.1.

Issued by : SLI Lichtsysteme  
 Date : 14.09.2004  
 Revision Date :

## DATA SHEET

Specification No.: 51P-5915  
 Supersedes :  
 Page 3 of 3